

305 WEST MAUMEE AVENUE
ILLEGAL DOWNSPOUT INVESTIGATION

2015

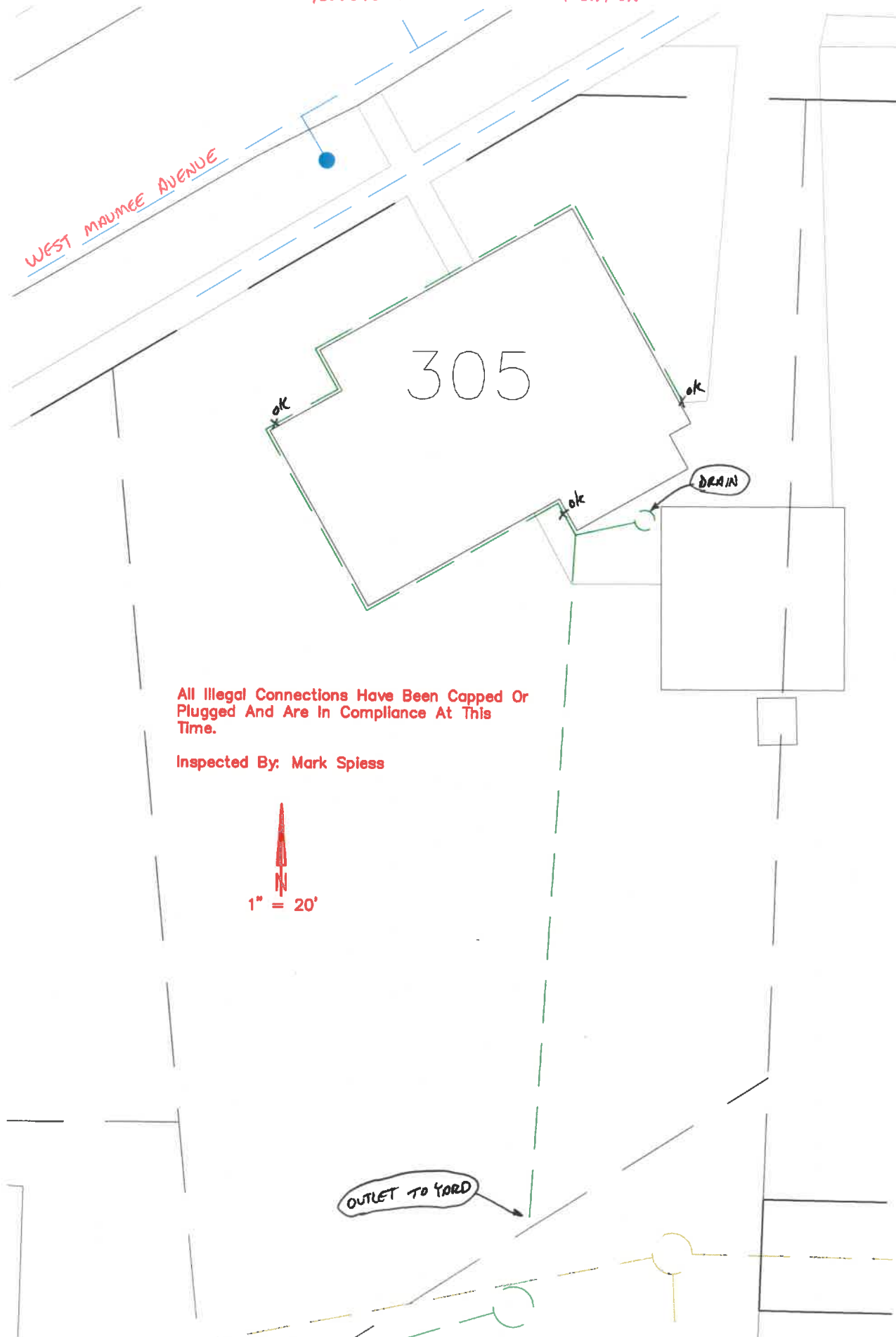

WEST MAUMEE AVENUE

305

DRAIN

OUTLET TO YARD

All Illegal Connections Have Been Capped Or
Plugged And Are In Compliance At This
Time.

Inspected By: Mark Spiess

